

## CONTACT US

---

 [www.realytech.com](http://www.realytech.com)

 [info@realytech.com](mailto:info@realytech.com)

---

# Product Catalog

Hang Zhou Realy Technology Limited Company



Distributed globally



High accuracy



speciality team







The first portable immunoanalyzer and supporting reagents were successfully put into production  
Awarded as Hangzhou Talent Enterprise  
Completed the pre-A round of financing

**2016**

More than 50 million tests of IVD reagent production have been sold.  
Product line was expanded to 300 categories.

**2018-2019**

**2017**

Passed GMP certification of State Food and Drug Administration, and obtained the first CFDA registration certificate; Got the European ISO13485 medical device quality management system certification, enter the European market.

**2020-2023**

Expanded the product line of COVID-19 detection and vigorously expanded overseas business, with annual sales exceeding \$200 million.

# ABOUT US

Hangzhou Realy Tech Co., Ltd. was founded in 2015. It is a Hangzhou, China headquartered and globally operated In-Vitro Diagnostic product manufacturer, specialized in clinical immunoassay field for more than 7 years. Realy name is well known in over 100 countries. The company sits on a 68,000 square meters science park and is equipped with state-of-the-art R&D and production facilities. Our manufacturing facility is ISO 13485 certified and has been inspected by China NMPA. Our broad product lines consist of Rapid Test, Drugs Test Readers, Portable immunoassay analyzer, and Automatic Chemiluminescence Immunoassay analyzer. All these systems are compatible with the detection of nearly 150 kinds of immune markers, test parameters covering cardiovascular diseases, infectious diseases, hepatitis disease, diabetes and other fields. It is not only suitable for rapid diagnosis of critical illnesses in large and medium-sized hospitals and labs, but also suitable for comprehensive immunological quantitative analysis of small and medium-sized hospitals and labs.



more...



- 
- **Automatic Chemiluminescence Immunoassay System**
  - **Portable Immunoassay Analyzer**
  - **Rapid Test**
  - **Covid-19 test solution**

# Contents

**01**

---

**Automatic Chemiluminescence  
Immunoassay System**

## Product performance

### ■ Industry-leading precision and accuracy

High level of accuracy from chemiluminescence technology



### ■ Flexible, reliable testing

Ability to run serum/plasma/Urine/Saliva/Hair samples  
8 simultaneous tests in under 20 minutes  
Flexibility to perform any of the assays



### ■ Simple. User-friendly

Single test reagent cartridge  
Color touchscreen controls  
Less than 4 steps to get accurate result

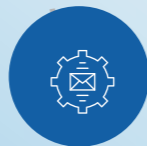

### ■ Quality and Compatibility

Easily interfaces with Laboratory Information Systems  
L-J, Westguard QC



# Automatic Chemiluminescence Immunoassay System

**Mini-CLIA**  
RL-C2000



**Mini-CLIA**  
RL-C4000



■ PRECISE ■ CONVENIENT ■ EFFICIENT



# Automatic Chemiluminescence Mini-CLIA

**Gold Standard**  
Top Quality



## Technical Specification:

Instrument type:	Bench-top Automatic Chemiluminescence Analyzer
Throughput:	Up to 8 samples or assays per run
Measuring time:	20 -40 mins
Measuring principle:	Chemiluminescent Microparticle Immunoassay(CMIA)
Sampling material:	Serum/Plasma/Urine/Saliva/Hair
Test mode:	Batch mode
Test speed:	>32 tests/hour
Calibration:	Factory Calibration, 2-point calibration every 90 days
Quality Control:	2 level-Lyophilised Quality Controls available
Monitor/Keyboard:	LCD Touchscreen
PC:	Integrated
Interface:	USB, RS232, Ethernet port supports LIS connection
Data storage:	Automatically stored
Weight:	25KGS
Dimensions:	525*480*530mm

## Instrument Features

Industry-leading precision and accuracy	<ul style="list-style-type: none"> <li>High level of accuracy from chemiluminescence technology</li> </ul>
Flexible, reliable testing	<ul style="list-style-type: none"> <li>Ability to run serum/plasma/Urine/Saliva/Hair samples</li> <li>8 simultaneous tests in under 20 minutes</li> <li>Flexibility to perform any of the assays</li> </ul>
Simple. User-friendly	<ul style="list-style-type: none"> <li>Single test reagent cartridge</li> <li>Color touchscreen controls</li> <li>Less than 4 steps to get accurate result</li> </ul>
Quality and Compatibility	<ul style="list-style-type: none"> <li>Easily interfaces with Laboratory Information Systems</li> <li>L-J, Westguard QC</li> </ul>

## Reagent Cartridge

### Reagent Cartridge:

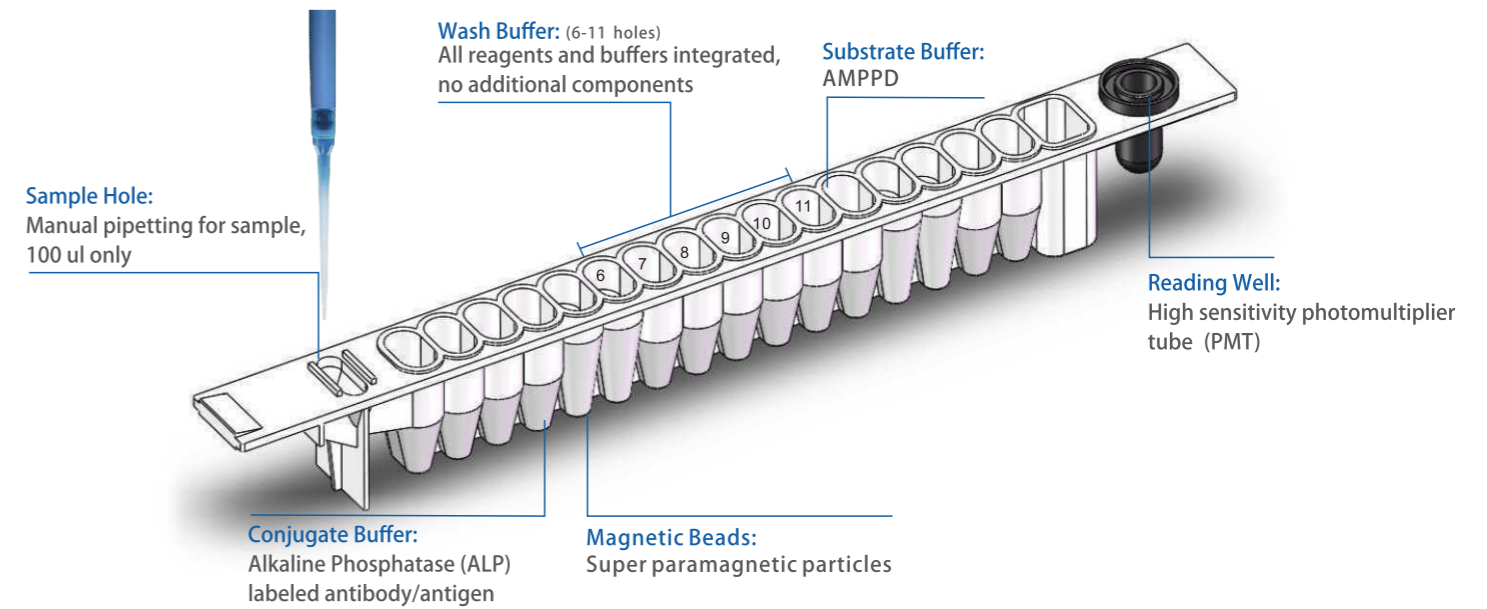

### Sandwich immunoassay:

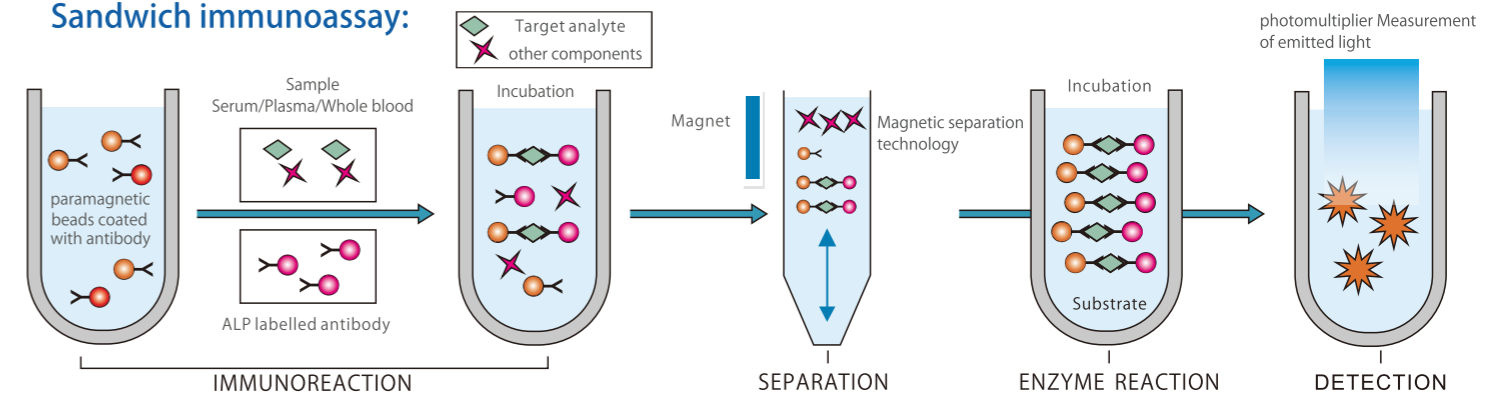

### Competitive immunoassay:

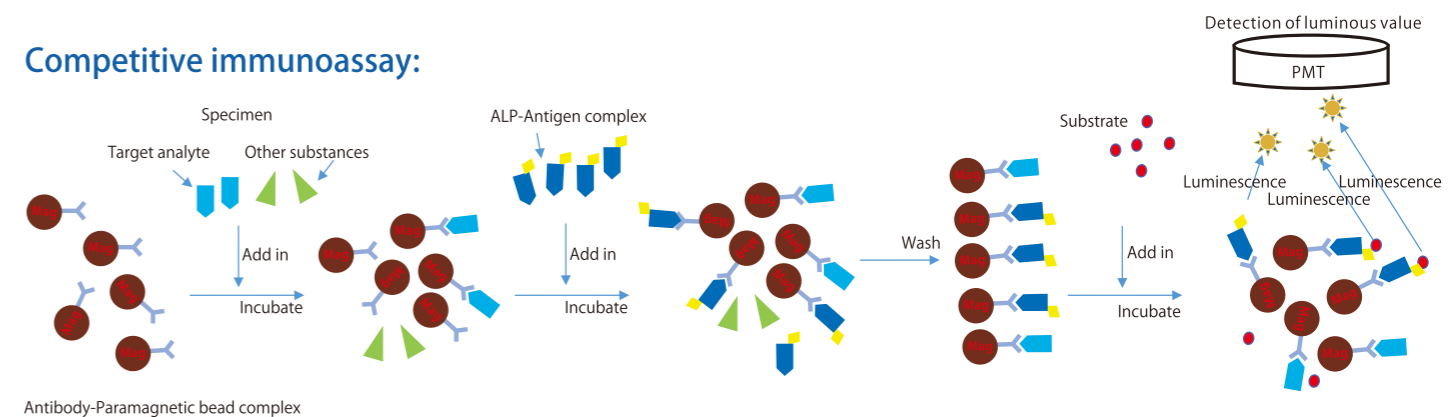

### Reagent features:

- State-of-the-art Chemiluminescence test method
- Single test concept, one sample, one cartridge, one result
- Precision: CV<10%
- Original Reagents, Calibrators & Quality controls with traceability system
- 18 months actual period of validity, 90 days calibration validity period



# Mini-CLIA Assay Solutions

Tumor Marker	Hormone	Infectious Disease	TORCH	Inflammatory Disease	Diabetes	Anemia
AFP <sub>ce</sub>	He4 <sub>ce</sub>	FSH <sub>ce</sub>	2019-nCoV-IgG <sub>ce</sub>	HSV-I IgG <sub>ce</sub>	HS-CRP <sub>ce</sub>	Insulin <sub>ce</sub>
CA15-3 <sub>ce</sub>	PR <sub>ce</sub>	PRL <sub>ce</sub>	2019-nCoV-IgM <sub>ce</sub>	HSV-I IgM <sub>ce</sub>	PCT <sub>ce</sub>	C-peptide <sub>ce</sub>
CA19-9 <sub>ce</sub>	ProGRP <sub>ce</sub>	PROG <sub>ce</sub>	COVID-nAb <sub>ce</sub>	HSV-II IgG <sub>ce</sub>	IL-6 <sub>ce</sub>	MALB <sub>ce</sub>
CA125 <sub>ce</sub>	β2-MG <sub>ce</sub>	E2 <sub>ce</sub>	MP IgG <sub>ce</sub>	HSV-II IgM <sub>ce</sub>	SAA <sub>ce</sub>	Folate <sub>ce</sub>
CEA <sub>ce</sub>	PAP <sub>ce</sub>	AMH <sub>ce</sub>	MP IgM <sub>ce</sub>	HSV-I/II IgG <sub>ce</sub>		
CYFRA21-1 <sub>ce</sub>	HER-2 <sub>ce</sub>	TESTO <sub>ce</sub>	DEN NS1 Ag <sub>ce</sub>	HSV-I/II IgM <sub>ce</sub>		
NSE <sub>ce</sub>	TPA <sub>ce</sub>	LH <sub>ce</sub>	Anti-TP <sub>ce</sub>	CMV IgG		
PGI <sub>ce</sub>		HCG <sub>ce</sub>	HBsAg	CMV IgM		
PGII <sub>ce</sub>		DHEA-S <sub>ce</sub>	HIV	Rubella IgG		
t-PSA		ACTH <sub>ce</sub>	HCV	Rubella IgM		
f-PSA		Cor <sub>ce</sub>	HBeAb	Toxo IgG		
SCCA <sub>ce</sub>		PAPP-A <sub>ce</sub>	HBeAg	Toxo IgM		
CA50 <sub>ce</sub>		uE3 <sub>ce</sub>	HBcAb			
CA242 <sub>ce</sub>		Free β-HCG <sub>ce</sub>	HBsAb			
CA72-4 <sub>ce</sub>			HRP-II <sub>ce</sub>			
PIVKA-II <sub>ce</sub>						

Thyroid Function	Cardiac Markers	Bone Metabolism	Rheumatoid arthritis	Thrombus	Allergy	DOA
Ft3 <sub>ce</sub>	NT-proBNP <sub>ce</sub>	25-OH VD <sub>ce</sub>	RF IgM <sub>ce</sub>	D-Dimer <sub>ce</sub>	Total IgE <sub>ce</sub>	MOP <sub>ce</sub>
Ft4 <sub>ce</sub>	hs-cTnl <sub>ce</sub>	PTH <sub>ce</sub>	Anti-CCP <sub>ce</sub>			MET <sub>ce</sub>
Tt3 <sub>ce</sub>	CK-MB <sub>ce</sub>	hGH <sub>ce</sub>				THC <sub>ce</sub>
Tt4 <sub>ce</sub>	MYO <sub>ce</sub>	Osteocalcin <sub>ce</sub>				OPI <sub>ce</sub>
TSH <sub>ce</sub>	Lp(a) <sub>ce</sub>					AMP <sub>ce</sub>
TG <sub>ce</sub>	MPO <sub>ce</sub>					KET <sub>ce</sub>
Anti-Tg <sub>ce</sub>	St2 <sub>ce</sub>					BZO <sub>ce</sub>
Anti-TPO <sub>ce</sub>	BNP <sub>ce</sub>					BUP <sub>ce</sub>
	cTnT					COC <sub>ce</sub>
						CATH <sub>ce</sub>
						MDMA <sub>ce</sub>

AFP: Launched PR: Coming soon

**Mini-CLIA**  
(RL-C2000)



## Performance for Infectious Disease / TORCH Chemiluminescence Test

Name	Specimen	Items Type	LOD	Linearity (r≥0.990)
HSV- I IgG	Serum/Plasma	TORCH	/	0.5-1000ng/mL
HSV- II IgG	Serum/Plasma	TORCH	/	1.0-300U/mL
Toxo IgG	Serum/Plasma	TORCH	0.5IU/ml	1.0-2000U/mL
Rub IgG	Serum/Plasma	TORCH	0.5IU/ml	1.0-5000U/mL
2019-nCoV-IgG	Serum/Plasma	Infectious Disease	/	0.2-600ng/mL
2019-nCoV-IgM	Serum/Plasma	Infectious Disease	/	0.1-100ng/mL
SARS-CoV2 Neu Ab	Serum/Plasma	Infectious Disease	2ng/mL	0.05-60ng/mL

Herpes Simplex Virus - I IgG (HSV- I IgG) Assay Reagent Kit (CMIA)	
CV%	QC-L=4.55%;QC-M=2.56%;QC-H=2.02%
Compared with a commercially available immunoassay	99.39% (95%CI: 98.22%~99.87%); n=491

Herpes Simplex Virus - II IgG (HSV- II IgG) Assay Reagent Kit (CMIA)	
CV%	QC-L=5.00%;QC-M=3.09%;QC-H=2.82%
Compared with a commercially available immunoassay	99.26% (95%CI: 98.12%~99.80%); n=541

Toxoplasma IgG (Toxo IgG) Assay Reagent Kit (CMIA)	
CV%	QC-L=7.21%;QC-M=5.46%;QC-H=6.78%
Compared with a commercially available immunoassay	99.39% (95%CI: 98.22%~99.87%); n=491

Rubella IgG (Rub IgG) Assay Reagent Kit (CMIA)	
CV%	QC-L=7.44%;QC-M=5.17%;QC-H=6.78%
Compared with a commercially available immunoassay	99.39% (95%CI: 98.22%~99.87%); n=49

2019-nCoV-IgG Assay Reagent Kit (CMIA)	
CV%	QC-L=1.66%;QC-M=4.01%;QC-H=3.72%
Compared with a commercially available immunoassay	99.43% (95%CI: 98.51%-99.84%); n=710

2019-nCoV-IgM Assay Reagent Kit (CMIA)	
CV%	QC-L=5.10%;QC-M=2.36%;QC-H=4.03%
Compared with a commercially available immunoassay	98.17% (95%CI: 96.29%-99.16%); n=710

Novel coronavirus neutralizing antibody Assay Reagent Kit (CMIA)	
CV%	QC-L=5.75%;QC-M=4.31%;QC-H=5.02%
Compared with a commercially available immunoassay	99.71% (95%CI: 98.41%-99.99%); n=349



## Performance for Inflammatory disease/Diabetes

### /Allergy Chemiluminescence Test

Name	Specimen	Items Type	LOD	Linearity (r≥0.990)
CK-MB	Serum/Plasma	Inflammatory disease	0.05mg/mL	0.10-20mg/mL
cTnl	Serum/Plasma	Inflammatory disease	0.02ng/mL	0.04-100ng/mL
Myo	Serum/Plasma	Diabetes	1 μIU/mL	1.0-500 μIU/mL
NT-proBNP	Serum/Plasma	Allergy	1IU/ml	5-2000IU/ml

#### High Sensitive C-Reactive Protein (hsCRP) Assay Reagent Kit (CMIA)

CV%	QC-L=4.17%;QC-M=5.21%;QC-H=3.26%
Compared with a commercially available immunoassay	y=1.0235x-0.0569; r=0.9835; n=125

#### Procalcitonin (PCT) Assay Reagent Kit (CMIA)

CV%	QC-L=6.98%;QC-M=6.78%;QC-H=5.19%
Compared with a commercially available immunoassay	y=0.9876x+0.0786; r=0.9862; n=99

#### Insulin (INS) Assay Reagent Kit (CMIA)

CV%	QC-L=3.63%;QC-M=4.02%;QC-H=2.35%
Compared with a commercially available immunoassay	y=0.9466x+0.4812; r=0.9885; n=96

#### Total Immunoglobulin E (Total IgE) Assay Reagent Kit (CMIA)

## Mini-CLIA Thyroid Function assay solutions

Name	Specimen	LOD	Linearity (r≥0.990)
Ft3	Serum/Plasma	0.5pg/mL	1.0-30pg/mL
Ft4	Serum/Plasma	0.1ng/dL	0.3-5.0ng/dL
Tt3	Serum/Plasma	0.25ng/mL	0.25-10ng/mL
Tt4	Serum/Plasma	10ng/mL	10-250ng/mL
TSH	Serum/Plasma	0.01mIU/L	0.05-100mIU/L

#### Free T3 (FT3) Assay Reagent Kit (CMIA)

CV%	QC-L=4.14%;QC-M=3.14%;QC-H=2.17%
Compared with a commercially available immunoassay	y=0.9637x+0.5354; r=0.9579; n=95

#### Free T4 (FT4) Assay Reagent Kit (CMIA)

CV%	QC-L=3.75%;QC-M=4.71%;QC-H=3.76%
Compared with a commercially available immunoassay	y=0.9777x+0.0369; r=0.9537; n=90

#### Total T3 (TT3) Assay Reagent Kit (CMIA)

CV%	QC-L=5.26%;QC-M=4.64%;QC-H=4.62%
Compared with a commercially available immunoassay	y=1.0368x-0.1062; r=0.9772; n=100

#### Total T4 (TT4) Assay Reagent Kit (CMIA)

CV%	QC-L=3.03%;QC-M=3.67%;QC-H=5.97%
Compared with a commercially available immunoassay	y=0.9761x+0.2677; r=0.957; n=83

#### Thyroid Stimulating Hormone (TSH) Assay Reagent Kit (CMIA)

CV%	QC-L=5.32%;QC-M=3.61%;QC-H=4.40%
Compared with a commercially available immunoassay	y=1.0588x-0.1355; r=0.9827; n=95



## Performance for Anemia/Bone Metabolism /Thrombus Chemiluminescence Test

Name	Specimen	Items Type	LOD	Linearity (r≥0.990)
Vb12	Serum/Plasma	Anemia	50pg/mL	50-2000pg/mL
Ferritin	Serum/Plasma	Anemia	1ng/mL	2-2000ng/mL
25-OH-Vitamin D	Serum/Plasma	Bone Metabolism	4ng/mL	4-160.0ng/mL
PTH	Serum/Plasma	Bone Metabolism	2pg/mL	2.0-5000pg/mL
D-Dimer	Plasma	Thrombus	0.05 μg/mL	0.1-20 μg/mL

### Vitamin B12 (VB12) Assay Reagent Kit (CMIA)

CV%	QC-L=4.81%;QC-M=2.71%;QC-H=3.19%
Compared with a commercially available immunoassay	y=0.9754x+10.4256; r=0.9831; n=102

### Ferritin (Fer) Assay Reagent Kit (CMIA)

CV%	QC-L=5.23%;QC-M=3.87%;QC-H=4.72%
Compared with a commercially available immunoassay	y=0.9732x-0.2375; r=0.9803; n=107

### 25-Hydroxy Vitamin D (25-OH VD) Assay Reagent Kit (CMIA)

CV%	QC-L=6.88%;QC-M=7.37%;QC-H=7.19%
Compared with a commercially available immunoassay	y=1.0288x-0.176; r=0.9869; n=121

### Parathyroid Hormone (PTH) Assay Reagent Kit (CMIA)

CV%	QC-L=7.19%;QC-M=5.33%;QC-H=6.63%
Compared with a commercially available immunoassay	y=1.0322x-0.3593; r=0.9756; n=87

### D-Dimer (DD) Assay Reagent Kit (CMIA)

CV%	QC-L=4.59%;QC-M=3.72%;QC-H=4.44%
Compared with a commercially available immunoassay	y=1.0911x-0.0209; r=0.9766; n=96

## Mini-CLIA Tumor Marker assay solutions

Name	Specimen	LOD	Linearity (r≥0.990)
AFP	Serum/Plasma	0.1ng/mL	0.5-1000ng/mL
CA15-3	Serum/Plasma	1U/mL	1.0-300U/mL
CA19-9	Serum/Plasma	1U/mL	1.0-2000U/mL
Ca125	Serum/Plasma	1U/mL	1.0-5000U/mL
CEA	Serum/Plasma	0.2ng/mL	0.2-600ng/mL
t-PSA	Serum/Plasma	0.05ng/mL	0.1-100ng/mL
f-PSA	Serum/Plasma	0.01ng/mL	0.05-60ng/mL

### Alpha-fetoprotein (AFP) Assay Reagent Kit (CMIA)

CV%	QC-L=4.27%;QC-M=3.43%;QC-H=4.51%
Compared with a commercially available immunoassay	y=1.0312x-0.8124; r=0.9876; n=95

### Carbohydrate Antigen 15-3 (CA15-3) Assay Reagent Kit (CMIA)

CV%	QC-L=4.71%;QC-M=4.52%;QC-H=5.33%
Compared with a commercially available immunoassay	y=1.0502x-0.2713; r=0.9882; n=122

### Carbohydrate Antigen 19-9 (CA19-9) Assay Reagent Kit (CMIA)

CV%	QC-L=5.32%;QC-M=6.00%;QC-H=4.80%
Compared with a commercially available immunoassay	y=1.0312x-0.377; r=0.9833; n=95

### Carbohydrate Antigen 125 (CA125) Assay Reagent Kit (CMIA)

CV%	QC-L=4.74%;QC-M=5.73%;QC-H=5.40%
Compared with a commercially available immunoassay	y=0.9733x+0.64; r=0.9879; n=116

### Carcinoembryonic Antigen (CEA) Assay Reagent Kit (CMIA)

CV%	QC-L=4.26%;QC-M=3.67%;QC-H=2.23%
Compared with a commercially available immunoassay	y=1.0136x-0.325; r=0.9837; n=100

### Total Prostate Specific Antigen (t-PSA) Assay Reagent Kit (CMIA)

CV%	QC-L=6.70%;QC-M=4.81%;QC-H=3.88%
Compared with a commercially available immunoassay	y=1.0237x-0.0658; r=0.9871; n=90

### Free Prostate Specific Antigen (f-PSA) Assay Reagent Kit (CMIA)

CV%	QC-L=6.70%;QC-M=4.81%;QC-H=5.51%
Compared with a commercially available immunoassay	y=1.0211x-0.0258; r=0.9811; n=92

## Mini-CLIA Hormone assay solutions

Name	Specimen	LOD	Linearity (r≥0.990)
FSH	Serum/Plasma	0.1mIU/mL	0.2-200mIU/mL
PRL	Serum/Plasma	0.1ng/mL	0.5-200ng/mL
PROG	Serum/Plasma	0.1ng/mL	0.10-40.00ng/mL
E2	Serum/Plasma	10pg/mL	10-2400pg/mL
β-HCG	Serum/Plasma	0.5mIU/mL	1-3500mIU/mL
AMH	Serum/Plasma	0.02ng/mL	0.05-23.00ng/mL
LH	Serum/Plasma	0.1mIU/mL	0.2-200mIU/mL
TESTO	Serum/Plasma	0.05ng/mL	0.1-20ng/mL

### Follicle-Stimulating Hormone (FSH) Assay Reagent Kit (CMIA)

CV%	QC-L=5.80%;QC-M=3.52%;QC-H=3.42%
Compared with a commercially available immunoassay	y=1.0277x-0.0757; r=0.9758; n=87

### Prolactin (PRL) Assay Reagent Kit (CMIA)

CV%	QC-L=5.42%;QC-M=3.10%;QC-H=3.10%
Compared with a commercially available immunoassay	y=1.0368x-0.4367; r=0.9887; n=95

### Progesterone (PROG) Assay Reagent Kit (CMIA)

CV%	QC-L=7.75%;QC-M=7.37%;QC-H=6.61%
Compared with a commercially available immunoassay	y=0.9868+0.1334; r=0.9823; n=95

### Estradiol (E2) Assay Reagent Kit (CMIA)

CV%	QC-L=8.13%;QC-M=7.08%;QC-H=4.80%
Compared with a commercially available immunoassay	y=1.0637x-0.0186; r=0.9737; n=80

### Beta-Human Chorionic Gonadotropin (β-HCG) Assay Reagent Kit (CMIA)

CV%	QC-L=7.63%;QC-M=5.08%;QC-H=7.02%
Compared with a commercially available immunoassay	y=1.0326x-0.2124; r=0.9837; n=95

### Anti-Mullerian Hormone (AMH) Assay Reagent Kit (CMIA)

CV%	QC-L=2.54%;QC-M=2.46%;QC-H=1.94%
Compared with a commercially available immunoassay	y=1.0504x+0.0481; r=0.9836; n=97

### Luteinizing Hormone (LH) Assay Reagent Kit (CMIA)

CV%	QC-L=2.29%;QC-M=3.01%;QC-H=3.65%
Compared with a commercially available immunoassay	y=1.0411x-0.2780; r=0.9873; n=108

### Testosterone (TESTO) Assay Reagent Kit (CMIA)

CV%	QC-L=7.74%;QC-M=6.25%;QC-H=5.64%
Compared with a commercially available immunoassay	y=1.0137x-0.0186; r=0.9837; n=113

## Mini-CLIA Cardiac Markers assay solutions

Items	Specimen	LOD	Linearity (r≥0.990)
CK-MB	Serum/Plasma	0.5ng/mL	2.0-300ng/mL
cTnl	Serum/Plasma	0.02ng/mL	0.05-50ng/mL
Myo	Serum/Plasma	2ng/mL	5-1000ng/mL
NT-proBNP	Serum/Plasma	25pg/mL	25-30000pg/mL

### Creatine Kinase MB (CK-MB) Assay Reagent Kit (CMIA)

CV%	QC-L=7.59%;QC-M=6.49%;QC-H=4.63%
Compared with a commercially available immunoassay	y=1.0057x-0.1946; r=0.9837; n=120

### High Sensitive Cardiac Troponin I (hs-cTnl) Assay Reagent Kit (CMIA)

CV%	QC-L=7.14%;QC-M=4.18%;QC-H=3.66%
Compared with a commercially available immunoassay	y=0.9859x+0.0098; r=0.9737; n=98

### Myoglobin (MYO) Assay Reagent Kit (CMIA)

CV%	QC-L=6.16%;QC-M=5.17%;QC-H=6.83%
Compared with a commercially available immunoassay	y=1.0757x-1.1946; r=0.9797; n=100

### N-terminal pro B-type Natriuretic Peptide (NT-proBNP) Assay Reagent Kit (CMIA)

CV%	QC-L=7.93%;QC-M=7.38%;QC-H=6.78%
Compared with a commercially available immunoassay	y=0.9737+12.8186; r=0.9677; n=100



## Mini-CLIA Hormone assay solutions

Name	Specimen	LOD	Linearity ( $r \geq 0.990$ )
FSH	Serum/Plasma	0.1mIU/mL	0.2-200mIU/mL
PRL	Serum/Plasma	0.1ng/mL	0.5-200ng/mL
PROG	Serum/Plasma	0.1ng/mL	0.10-40.00ng/mL
E2	Serum/Plasma	10pg/mL	10-2400pg/mL
$\beta$ -HCG	Serum/Plasma	0.5mIU/mL	1-3500mIU/mL
AMH	Serum/Plasma	0.02ng/mL	0.05-23.00ng/mL
LH	Serum/Plasma	0.1mIU/mL	0.2-200mIU/mL
TESTO	Serum/Plasma	0.05ng/mL	0.1-20ng/mL

### Follicle-Stimulating Hormone (FSH) Assay Reagent Kit (CMIA)

CV%	QC-L=5.80%;QC-M=3.52%;QC-H=3.42%
Compared with a commercially available immunoassay	$y=1.0277x-0.0757$ ; $r=0.9758$ ; $n=87$

### Prolactin (PRL) Assay Reagent Kit (CMIA)

CV%	QC-L=5.42%;QC-M=3.10%;QC-H=3.10%
Compared with a commercially available immunoassay	$y=1.0368x-0.4367$ ; $r=0.9887$ ; $n=95$

### Progesterone (PROG) Assay Reagent Kit (CMIA)

CV%	QC-L=7.75%;QC-M=7.37%;QC-H=6.61%
Compared with a commercially available immunoassay	$y=0.9868+0.1334$ ; $r=0.9823$ ; $n=95$

### Estradiol (E2) Assay Reagent Kit (CMIA)

CV%	QC-L=8.13%;QC-M=7.08%;QC-H=4.80%
Compared with a commercially available immunoassay	$y=1.0637x-0.0186$ ; $r=0.9737$ ; $n=80$

### Beta-Human Chorionic Gonadotropin ( $\beta$ -HCG) Assay Reagent Kit (CMIA)

CV%	QC-L=7.63%;QC-M=5.08%;QC-H=7.02%
Compared with a commercially available immunoassay	$y=1.0326x-0.2124$ ; $r=0.9837$ ; $n=95$

### Anti-Mullerian Hormone (AMH) Assay Reagent Kit (CMIA)

CV%	QC-L=2.54%;QC-M=2.46%;QC-H=1.94%
Compared with a commercially available immunoassay	$y=1.0504x+0.0481$ ; $r=0.9836$ ; $n=97$

### Luteinizing Hormone (LH) Assay Reagent Kit (CMIA)

CV%	QC-L=2.29%;QC-M=3.01%;QC-H=3.65%
Compared with a commercially available immunoassay	$y=1.0411x-0.2780$ ; $r=0.9873$ ; $n=108$

### Testosterone (TESTO) Assay Reagent Kit (CMIA)

CV%	QC-L=7.74%;QC-M=6.25%;QC-H=5.64%
Compared with a commercially available immunoassay	$y=1.0137x-0.0186$ ; $r=0.9837$ ; $n=113$

## Mini-CLIA Cardiac Markers assay solutions

Items	Specimen	LOD	Linearity ( $r \geq 0.990$ )
CK-MB	Serum/Plasma	0.5ng/mL	2.0-300ng/mL
cTnl	Serum/Plasma	0.02ng/mL	0.05-50ng/mL
Myo	Serum/Plasma	2ng/mL	5-1000ng/mL
NT-proBNP	Serum/Plasma	25pg/mL	25-30000pg/mL

### Creatine Kinase MB (CK-MB) Assay Reagent Kit (CMIA)

CV%	QC-L=7.59%;QC-M=6.49%;QC-H=4.63%
Compared with a commercially available immunoassay	$y=1.0057x-0.1946$ ; $r=0.9837$ ; $n=120$

### High Sensitive Cardiac Troponin I (hs-cTnl) Assay Reagent Kit (CMIA)

CV%	QC-L=7.14%;QC-M=4.18%;QC-H=3.66%
Compared with a commercially available immunoassay	$y=0.9859x+0.0098$ ; $r=0.9737$ ; $n=98$

### Myoglobin (MYO) Assay Reagent Kit (CMIA)

CV%	QC-L=6.16%;QC-M=5.17%;QC-H=6.83%
Compared with a commercially available immunoassay	$y=1.0757x-1.1946$ ; $r=0.9797$ ; $n=100$

### N-terminal pro B-type Natriuretic Peptide (NT-proBNP) Assay Reagent Kit (CMIA)

CV%	QC-L=7.93%;QC-M=7.38%;QC-H=6.78%
Compared with a commercially available immunoassay	$y=0.9737+12.8186$ ; $r=0.9677$ ; $n=100$



# 02

---

**Portable Immunoassay Analyzer**



Family ,Community hospital, Inspection department, Clinical laboratory and Emergency departments

# Quantitative Immunoassay Analyzer



## A2000



### Features

- Handheld operation
- Multi-language version available
- Variety of detection mode
- 2.8 inch colorful touch screen
- Upgrade software automatically
- Mass memory and data traceability
- Built-in virtual keyboard
- Battery duration 72 hours

### Procedure:

- Add samples
- #### 1.For whole blood(two types)

##### Special one:

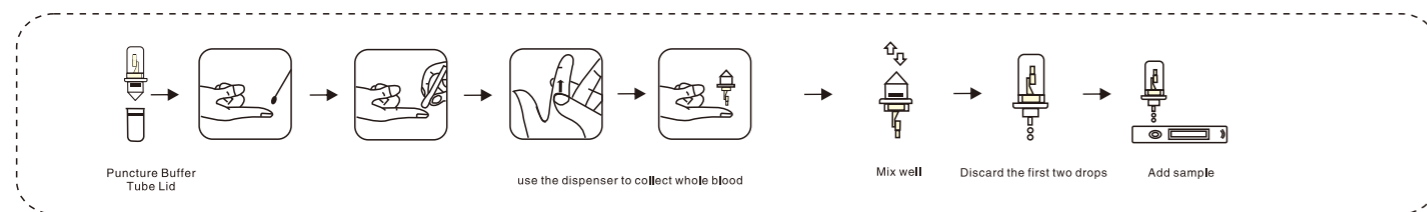

##### Ordinary one:

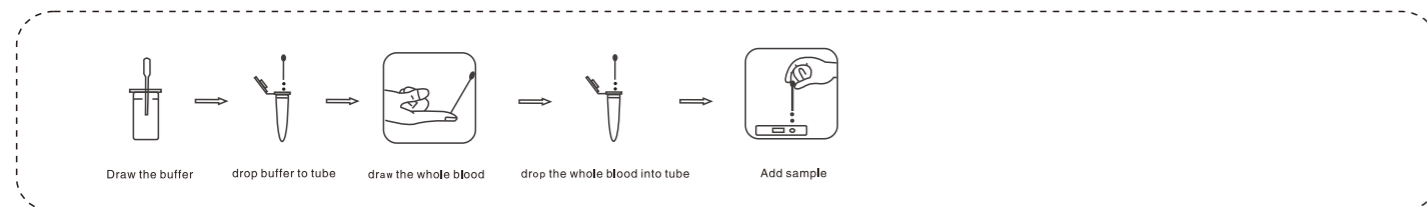

##### Special one:

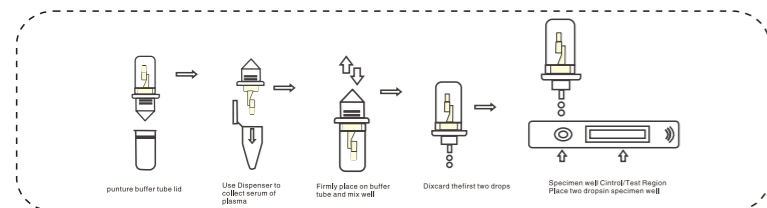

##### Ordinary one:

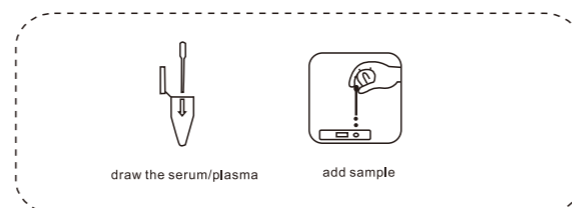

Product Name	Specimen
Procalcitonin Rapid Test Device (Colloidal Gold) <small>CE</small>	S/P/W
C-reactive Protein Rapid Test Device(Colloidal Gold) <small>CE</small>	S/P/W
D-Dimer Rapid Test Device (Colloidal Gold) <small>CE</small>	P/W
N-terminal pro-Brain Natriurtic Peptide Rapid Test Device(Colloidal Gold) <small>CE</small>	S/P/W
IgE Rapid Test Device <small>CE</small>	S/P/W
FOB Rapid Test Device <small>CE</small>	Feces
Calprotection Rapid Test Device(Feces) <small>CE</small>	Feces
SAA Rapid Test Device (Colloidal Gold) <small>CE</small>	S/P/W
IL-6 Rapid Test Device (Colloidal Gold) <small>CE</small>	S/P/W
Strep A Rapid Test Device(Throat swab) <small>CE</small>	Swab
Cardiac Troponin I Rapid Test Device (Colloidal Gold) <small>CE</small>	S/P/W
PSA Rapid Test Device(Serum/Plasma/Whole Blood)	S/P/W
Creatine Kinase-MB Rapid Test Device (Colloidal Gold) <small>CE</small> *	S/P/W
Myoglobin Rapid Test Device (Whole Blood/Serum/Plasma) <small>CE</small> *	S/P/W
Cystatin C Rapid Test Device (Colloidal Gold) <small>CE</small> *	S/P
Urinary microalbumin Rapid Test Device (Urine) <small>CE</small> *	Urine
β2-microglobulin Rapid Test Device (Colloidal Gold) <small>CE</small> *	S/P/Urine
H. Pylori Antigen Rapid Test Device <small>CE</small> *	Feces
Ferritin Rapid Test Device(Whole blood/Serum/Plasma) <small>CE</small> *	S/P/W
Transferrin Rapid Test Device <small>CE</small> *	Feces
Norovirus Rapid Test Device <small>CE</small> *	Feces
The VB12 Rapid Test <small>CE</small> *	S/P/W
The 25-OH-VD Rapid Test <small>CE</small> *	S/P/W

\* :coming soon





# 03

---

## Rapid Test



# Infectious Disease Tests

## Rapid Test Device

- Accurate
- Fast
- Easy



# Infectious Disease Tests

- Accurate
- Fast
- Easy

Product Description	REF	Specimen	Ce
Adenovirus Rapid Test Device	K010416D	feces	*
Adenovirus/Rotavirus Combo Rapid Test Device	K020416D	stool	*
Chikungunya IgG/IgM Rapid Test Device	K030216D	WB/S/P	*
Dengue IgG/IgM and NS1 Rapid Test Device	K040216D	WB/S/P	*
Dengue IgG/IgM Rapid Test Device	K050216D	WB/S/P	*
Dengue NS1 Rapid Test Device	K060216D	WB/S/P	*
Filariasis IgG/IgM Rapid Test Device	K070216D	WB/S/P	*
HEV IgM Rapid Test Device	K080116D	S/P	*
HAV IgG/IgM Rapid Test Device	K090116D	S/P	*
HAV IgM Rapid Test Device	K100116D	S/P	*
Influenza A&B Rapid Test Device	K251316D	throat swab	*
Influenza A&B Rapid Test Strip	K251316S	throat swab	*
Infectious Mononucleosis IgM Rapid Test Device	K260216D	WB/S/P	*
Malaria Pf. Rapid Test Device	K270916D	whole blood	*
Malaria Pf./P.v. Rapid Test Device	K280916D	whole blood	*
Malaria Pf./Pan Antigen Rapid Test Device	K290916D	whole blood	*
Norovirus Rapid Test Device	K300416D	feces	*
Rotavirus Rapid Test Device	K320416D	feces	*
Strep A Rapid Test Device	K341316D	throat swab	*
Strep A Rapid Test Strip	K341316S	throat swab	*
Syphilis Rapid Test Device	K350116D	serum or plasma	*
Syphilis Rapid Test Strip	K350116S	serum or plasma	*
Syphilis Rapid Test Device	K350216D	WB/S/P	*
Syphilis Rapid Test Strip	K350216S	WB/S/P	*
Typhoid IgG/IgM Rapid Test Device	K370116D	S/P	*
Typhoid IgG/IgM Rapid Test Strip	K370116S	S/P	*
Typhoid IgG/IgM Rapid Test Device	K370216D	WB/S/P	*
Tuberculosis Rapid Test Device	K380216D	WB/S/P	*
Tuberculosis Rapid Test Strip	K380216S	WB/S/P	*
Leptospira IgG/IgM Rapid Test Device	K450116D	WB/S/P	*
Salmonella Antigen Rapid Test Device	K500416D	feces	*
Novel Coronavirus (2019-nCoV) Antigen Rapid Test Cassette	K531416D	Nasal Swab and nasal aspirate	*
SARS-Cov-2&Influenza A&B Combo Rapid Test Cassette	K541416D	Nasopharyngeal swab	*
Adenovirus Rapid Test Device	K561416D	Nasal Swab and nasal aspirate	*
Novel coronavirus (SARS-Cov-2) neutralizing antibody Rapid Test Device	K580216D	WB/S/P	*
Novel Coronavirus(COVID -19) Neutralizing Antibody Rapid Test Device	K660216D	WB/S/P	*
2019-nCoV IgG/IgM Rapid Test Device	K460216D	WB/S/P	*
Novel Coronavirus (SARS-Cov-2) Antigen Rapid Test Cassette	K511416D	Nasal Swab and nasal aspirate	*
Novel Coronavirus (SARS-Cov-2) Antigen Rapid Test Device	K700516D	saliva	*
Novel Coronavirus (SARS-Cov-2) Antigen Rapid Test Device	K721416D	nasal swab	*
Novel Coronavirus (SARS-Cov-2) Antigen Rapid Test	K730516D	oral fluid	*
One Step Novel Coronavirus (SARS-Cov-2) Antigen Rapid Test	K740516D	oral fluid	*
Novel Coronavirus (SARS-Cov-2) Antigen Rapid Test Device	K601416D	nasal swab	*
Novel Coronavirus (SARS-Cov-2) Antigen Rapid Test Device	K590516D	saliva	*
SARS-Cov-2&Influenza A/B Combo Rapid Test Cassette	K751416D	nasal swab	*
RSV Rapid Test Device	K311416D	Nasal Swab and nasal aspirate	*



# Infectious Disease Tests

- Accurate
- Fast
- Easy

Product Description	REF	Specimen	Ce
S.typhi Antigen Rapid Test Device	K360416D	feces	*
Typhoid IgG/IgM Rapid Test	K370216T	S/P	*
HPV IgM Rapid Test Device	K410216D	serum	*
M.Pneumonia IgG/IgM Rapid Test Device	K670216D	WB/S/P	*
M.Pneumonia Antigen Rapid Test Device	K681416D	swab	*
SARS -Cov -2&FLU A&B & RSV & Adv Combo Rapid Test Cassette	K551416D	Nasopharyngeal swab	*
2-IN-1 COVID -19 Antigen Rapid Test Device	K711616D	Oropharyngeal saliva and nasal swab	*
The L.pn Rapid Test Device	K780316D	urine	*
Influenza A&B Rapid Test	K251316T	Nasopharyngeal swab	*
2-IN-1 COVID -19 Antigen Rapid Test Device	K791416D	Nasopharyngeal swab, saliva and exudate of blain	*
Human Monkeypox Virus (MPV) IgG/IgM Antibody Rapid Test Device	K760216D	WB/S/P	*
Human Monkeypox Virus (MPV) Antigen Rapid Test Device	K771616D	Nasopharyngeal swab, saliva and exudate of blain	*
Rubella IgG/IgM Rapid Test Device	K330116D	S/P	
Rubella IgG/IgM Rapid Test Device	K330216D	WB/S/P	
Brucella IgG/IgM Rapid Test Device	K390216D	WB/S/P	
Brucella IgM Rapid Test Device	K400216D	WB/S/P	
Rubella IgG Rapid Test Device	K481416D	S/P	
Rubella IgM Rapid Test Device	K491416D	S/P	
HBsAg Rapid Test Device	K110216D	WB/S/P	
HBsAg Rapid Test Strip	K110216S	WB/S/P	
HBsAg Rapid Test Device	K110116D	S/P	
HBsAg Rapid Test Strip	K110116S	S/P	
HBsAb Rapid Test Device	K120116D	S/P	
HBsAb Rapid Test Strip	K120116S	S/P	
HBeAg Rapid Test Device	K130116D	S/P	
HBeAg Rapid Test Device	K130216D	WB/S/P	
HBc Ab Rapid Test Device	K140116D	S/P	
HBeAb Rapid Test Device	K150116D	S/P	
HBsAg/HCV Combo Rapid Test Device	K160116D	S/P	
HBV Combo Rapid Test Device	K170116D	S/P	
HBsAg/HCV/HIV/Syphilis Combo Rapid Test Device	K180116D	S/P	
HBsAg/HCV/HIV Combo Rapid Test Device	K190116D	S/P	
HCV Rapid Test Device	K200216D	WB/S/P	
HCV Rapid Test Device	K200116D	S/P	
HCV Rapid Test Strip	K200116S	S/P	
HCV Rapid Test Strip	K200216S	WB/S/P	
Rapid 1/2/O Test Device	K210216D	WB/S/P	
HIV Rapid Test Device	K220216D	WB/S/P	
HIV Rapid Test Strip	K220216S	WB/S/P	
HIV Rapid Test Device	K220116D	S/P	
HIV Ag/Ab Combo Rapid Test Device	K230216D	WB/S/P	
HIV/Syphilis Combo Rapid Test Device	K240116D	S/P	
HIV 1/2 and HIV P24 combo Rapid Test Device	K420216D	WB/S/P	
HBsAg/HCV/HIV/Syphilis/HP Combo Rapid Test Device	K440116D	S/P	
HIV 1/2/O Rapid Test Device	K210116D	S/P	

## Product display



Hang Zhou Realy Tech Co.,Ltd.

#2 Building, No.763, Yuansha Village, Xinjie Street  
Xiaoshan District, 311200 Hangzhou City, Zhejiang  
Province PEOPLE'S REPUBLIC OF CHINA



+ 86-571-5605 0793

www.realytech.com



# Drug of Abuse Tests

## Rapid Test Device

- Accurate
- Fast
- Easy



## Drug of Abuse Tests

Product Description	REF	Specimen	Ce	
Portable Urine Cup Drug Test Analyzer	04L040316U	urine	*	
Portable Saliva Cup Drug Test Analyzer	04L040516S	saliva	*	
Multi-Drug Rapid Test Card	16L010316C	urine	*	
Multi-Drug Rapid Test Device	16L010316D	urine	*	
AMP Rapid Test	01L010316C	urine	*	
AMP Rapid Test	01L010316D	urine	*	
AMP Rapid Test	01L010316S	urine	*	
BZO Rapid Test	01L040316C	urine	*	
BZO Rapid Test	01L040316S	urine	*	
BZO Rapid Test	01L040316D	urine	*	
Alcohol Rapid Test	01L230316T	urine	*	
COC Rapid Test	01L050316C	urine	*	
COC Rapid Test	01L050316D	urine	*	
COC Rapid Test	01L050316S	urine	*	
Cocaine Rapid Test Strip Card Device	01L050316T	urine	*	
COT Rapid Test	01L200316C	urine	*	
COT Rapid Test	01L200316D	urine	*	
COT Rapid Test	01L200316S	urine	*	
Ethyl Glucuronide (ETG) Rapid Test (Urine) Rapid Test	01L060316C	urine	*	
Ethyl Glucuronide (ETG) Rapid Test (Urine) Rapid Test	01L060316D	urine	*	
Ethyl Glucuronide (ETG) Rapid Test (Urine) Rapid Test	01L060316S	urine	*	
Marijuana (THC) Rapid Test	01L180316C	urine	*	
Marijuana (THC) Rapid Test	01L180316D	urine	*	
Marijuana (THC) Rapid Test	01L180316S	urine	*	
Methamphetamine (MET) Rapid Test	01L340316C	urine	*	
Methamphetamine (MET) Rapid Test	01L340316D	urine	*	
Methamphetamine (MET) Rapid Test	01L340316S	urine	*	
Opiates (OPI) Rapid Test	01L130316C	urine	*	
Opiates (OPI) Rapid Test	01L130316D	urine	*	
Opiates (OPI) Rapid Test	01L130316S	urine	*	
The Drug Rapid Test (Saliva)		Saliva	*	
The Drug Rapid Test (Urine)	AMP/COC/MET/THC/MOP/BZO	06L060316T	urine	*
	AMP/MET/THC/MOP/BZO	05L040316T		
	AMP/BZO/OPI/THC/Alcohol (ALC)	05L050316T		
	ALC/BZO/BUK/KET/MDMA/OPI/COC、THC/MET、MOP	10L080316T		
	AMP/BZO/OPI/THC/ALC	05L060316T		



# Tumor & Cardiac Marker Tests

## Rapid Test Device

- Accurate
- Fast
- Easy



# Tumor & Cardiac Marker Tests

## Tumor Marker Tests

Product Description	REF	Specimen	Ce
H. Pylori Antigen Rapid Test Device	J030416D	feces	*
H. Pylori Antigen Rapid Test Strip	J030416S	feces	*
AFP Rapid Test Device	J040216D	WB/S/P	*
Ferritin Rapid Test Device (Colloidal Gold)	J060216D	WB/S/P	*
FOB Rapid Test Device	J100416D	feces	*
CEA Rapid Test Device (Whole Blood/ Serum/ Plasma)	J110216D	WB/S/P	*
H. Pylori (HP) Antibody Rapid Test Device	J130116D	S/P	*
H.Pylori (HP) Antibody Rapid Test Device	J130216D	WB/S/P	*
Transferrin Rapid Test Device	J140416D	feces	*
IgE Rapid Test Device	J080216D	WB/S/P	*
The CALP Rapid Test Device	J120416D	feces	*
PSA Rapid Test Device(Serum Plasma Whole Blood)	J050216D	WB/S/P	*

## Cardiac Marker Tests

Product Description	REF	Specimen	Ce
Procalcitonin Rapid Test Device (Colloidal Gold)	A010116D	S/P	*
Procalcitonin Rapid Test Device (Colloidal Gold)	A010216D	WB/S/P	*
C-reactive Protein Rapid Test Device(Colloidal Gold)	A020216D	WB/S/P	*
D-Dimer Rapid Test Device (Colloidal Gold)	B011116D	plasma	*
D-Dimer Rapid Test Device (Colloidal Gold)	B011016D	WB/P	*
D-Dimer Rapid Test Device (Colloidal Gold)	B010216D	WB/S/P	*
Cardiac Troponin I Rapid Test Device (Colloidal Gold)	D010216D	WB/S/P	*
CK MB Rapid Test Device (Whole Blood /Serum /Plasma)	D030216D	WB/S/P	*
Myoglobin Rapid Test Device (Whole Blood/Serum/Plasma)	D040216D	WB/S/P	*
Myoglobin/CK MB/Troponin I Combo Rapid Test Device	D060216D	WB/S/P	*
Cardiac Troponin I Rapid Test Device(Colloidal Gold)	D070216D	WB/S/P	*
NT-pro BNP Rapid Test Device (Colloidal Gold)	E010216D	WB/S/P	*
NT-proBNP Rapid Test Device(Colloidal Gold)	E010116D	S/P	*

## Hang Zhou Realy Tech Co.,Ltd.

#2 Building, No.763, Yuansha Village, Xinjie Street  
Xiaoshan District, 311200 Hangzhou City, Zhejiang  
Province PEOPLE'S REPUBLIC OF CHINA

+ 86-571-5605 0793  
www.realytech.com



# Women health Tests

## Rapid Test Device

- Accurate
- Fast
- Easy



## Women health Tests

Product Description	REF	Specimen	Ce
LH Rapid Test Device	G040316D	urine	*
FSH Rapid Test Strip	G050316S	urine	*
hCG Rapid Test Device	G070116D	S/P	*
hCG Rapid Test Midstream	G070316M	urine	*
hCG Rapid Test Strip	G070316S	urine	*
hCG Rapid Test Strip	G070316D	urine	*
hCG Rapid Test Device	G070816D	S/P/U	*
Vaginal pH Rapid Test Panel	G081316C	vaginal swab	*
Gonorrhea Rapid Test Device	G111316D	female cervical swab and male urethral swab	*
TSH Rapid Test Device	G160216D	WB/S/P	*
FSH Rapid Test Device	G050316D	urine	*
hCG Rapid Test	G071216T	S/U	*
LH Rapid Test	G040316T	urine	*
Chlamydia Rapid Test Device	G091316D	S/U	
CMV IgG/IgM Rapid Test Device	G100116D	S/P	
CMV IgG/IgM Rapid Test Device	G100216D	WB/S/P	
Gonorrhea and Chlamydia Combo Rapid Test Device	G121316D	检测女性宫颈拭子、男性尿道拭子	
ToRCH Rapid Test Device	G150116D	S/P	
TOXO IgG/IgM Rapid Test Device	G170116D	S/P	
TOXO IgG/IgM Rapid Test Device	G170216D	WB/S/P	
TOXO IgM Rapid Test Device	G180116D	S/P	
CMV IgM Rapid Test Device	G190116D	S/P	
CMV IgG Rapid Test Device	G200116D	S/P	
TOXO IgG Rapid Test Device	G210116D	S/P	
TORCH IgM(TOXO, Rubella, CMV, HSV-I, HSV-II) combo test	G220216D	WB/S/P	
TORCH IgG(TOXO, Rubella, CMV, HSV-I, HSV-II) combo test	G230216D	WB/S/P	
HSV 1/2 IgG/IgM Rapid Test Device	G130216D	WB/S/P	
HSV 2 IgG/IgM Rapid Test Device	G140216D	WB/S/P	





# 04

---

## Covid-19 test solution

## Professional use

Product name	tests/kit	types	CE
Novel coronavirus(SARS-Cov-2)antigen rapid test cassette(swab)	25	swab	*
Novel coronavirus(SARS-Cov-2)antigen rapid test cassette(swab)	5	swab	*
Novel coronavirus(SARS-Cov-2)antigen rapid test cassette(swab)	1	swab	*
Novel coronavirus(SARS-Cov-2)antigen rapid test device(nasal swab)	25	nasal swab	*
Novel coronavirus(SARS-Cov-2)antigen rapid test device(nasal swab)	5	nasal swab	*
Novel coronavirus(SARS-Cov-2)antigen rapid test device(nasal swab)	1	nasal swab	*
Novel coronavirus(SARS-Cov-2)antigen rapid test device(saliva)	20	saliva	*
Novel coronavirus(SARS-Cov-2)antigen rapid test device(saliva)	5	saliva	*
Novel coronavirus(SARS-Cov-2)antigen rapid test device(saliva)	1	saliva	*
SARS-Cov-2&Influenza A&B combo rapid test (swab)	25	swab	*
SARS-Cov-2&Influenza A&B combo rapid test (swab)	5	swab	*
Covid 2019 IgG/IgM rapid test device	25	serum/plasma /whole blood.	*
Covid 2019 IgG/IgM rapid test device	1	serum/plasma /whole blood.	*

## Professional use

### SARS-Cov-2 Antigen Test



Novel coronavirus (sars-cov-2) antigen rapid test cassette (swab)---K511416D

### SARS-Cov-2 Antigen Test



Novel coronavirus (sars-cov-2) antigen rapid test Device (Saliva)----K590516D

### SARS-Cov-2 & Influenza A&B Combo Test



SARS-Cov-2 & Influenza A & B Combo Rapid Test Cassette (swab)---K541416D

### SARS-Cov-2 Antibody Test



Novel Coronavirus (COVID-19) Neutralizing Antibody Rapid Test Device (Blood)---K660216D

## Product

### SARS-Cov-2 Antibody Test

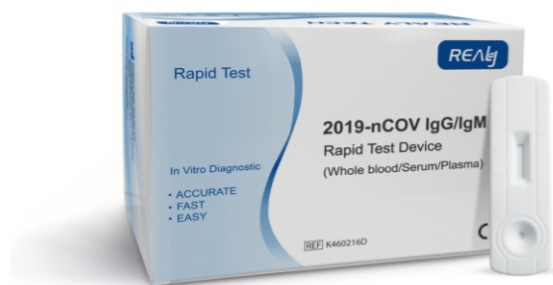

2019-nCoV IgG/IgM Rapid Test Device (Blood)---K460216D

### SARS-Cov-2 Antigen Test



Novel coronavirus (sars-cov-2) antigen rapid test cassette (Nasal swab)---K601416D

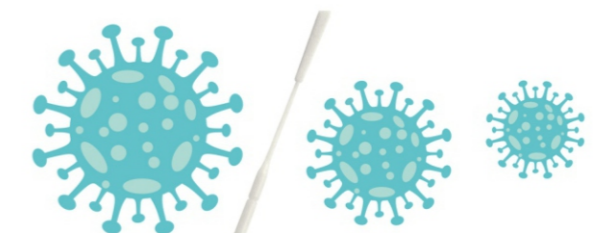

- ✓ ACCURATE
- ✓ FAST
- ✓ EASY



## Self test

Product name	tests/kit	types	CE
Novel coronavirus(SARS-Cov-2)antigen rapid test device(saliva)	20	saliva	*
Novel coronavirus(SARS-Cov-2)antigen rapid test device(saliva)	5	saliva	*
Novel coronavirus(SARS-Cov-2)antigen rapid test device(saliva)	1	saliva	*
Novel coronavirus(SARS-Cov-2)antigen rapid test device(nasal swab)	25	nasal swab	*
Novel coronavirus(SARS-Cov-2)antigen rapid test device(nasal swab)	5	nasal swab	*
Novel coronavirus(SARS-Cov-2)antigen rapid test device(nasal swab)	2	nasal swab	*
Novel coronavirus(SARS-Cov-2)antigen rapid test device(nasal swab)	1	nasal swab	*
One Step Novel coronavirus(SARS-Cov-2)antigen rapid test (Oral Fluid)	25	Oral Fluid	*
One Step Novel coronavirus(SARS-Cov-2)antigen rapid test (Oral Fluid)	5	Oral Fluid	*
One Step Novel coronavirus(SARS-Cov-2)antigen rapid test (Oral Fluid)	2	Oral Fluid	*
One Step Novel coronavirus(SARS-Cov-2)antigen rapid test (Oral Fluid)	1	Oral Fluid	*
SARS-Cov-2&Influenza A&B combo rapid test (swab)	25	swab	*
SARS-Cov-2&Influenza A&B combo rapid test (swab)	5	swab	*
SARS-Cov-2&Influenza A&B combo rapid test (swab)	2	swab	*
SARS-Cov-2&Influenza A&B combo rapid test (swab)	1	swab	*

## Product

### SARS-Cov-2&Influenza A/B combo Test



SARS-Cov-2&Influenza A/B  
combo rapid test (swab)for self-test

### One Step SARS-Cov-2 Antigen Test



One Step Novel coronavirus(SARS-Cov-2)  
antigen rapid test (Oral Fluid)for self-test

## Self test

### SARS-Cov-2 Antigen Test



Novel coronavirus(SARS-Cov-2)  
antigen rapid test device(nasal swab) for self-test

### SARS-Cov-2 Antigen Test



Novel coronavirus(SARS-Cov-2)  
antigen rapid test device(saliva) for self-test







Add: Hangzhou Realy Tech Co., Ltd. #2 Building,  
No. 763, Yuansha Village, Xinjie Street,  
Xiaoshan District, 311200 Hangzhou City, Zhejiang  
Province, PEOPLE'S REPUBLIC OF CHINA

Tel: +86 0571-56050793  
Website: [www.realytech.com](http://www.realytech.com)  
e-mail: [info@realytech.com](mailto:info@realytech.com)